

DETAIL 1 DOORSNEDE

SCHAAL 1 : 10
Doorsnede leuning

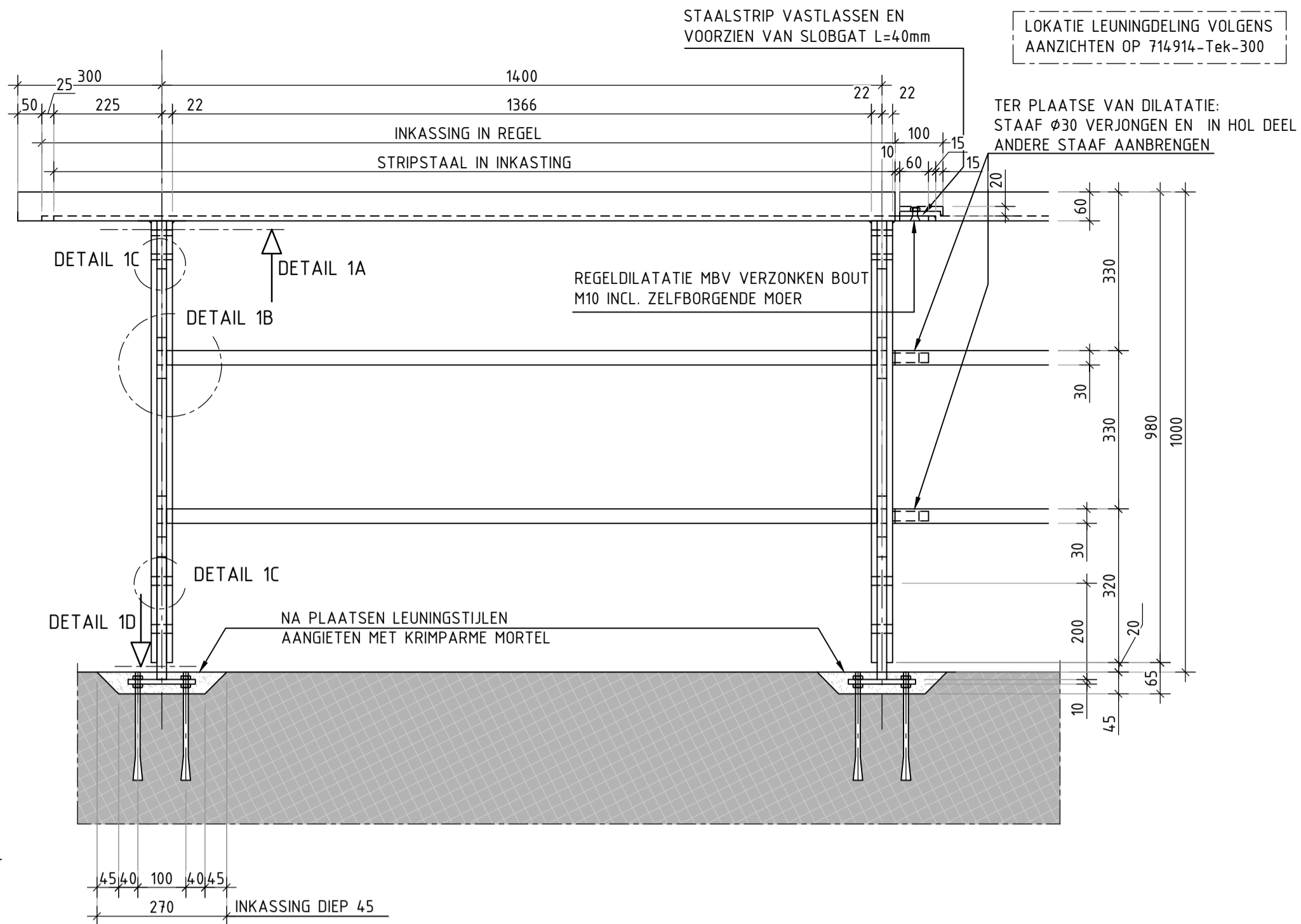

DETAIL 1 AANZICHT

SCHAAL 1 : 10
Aanzicht leuning

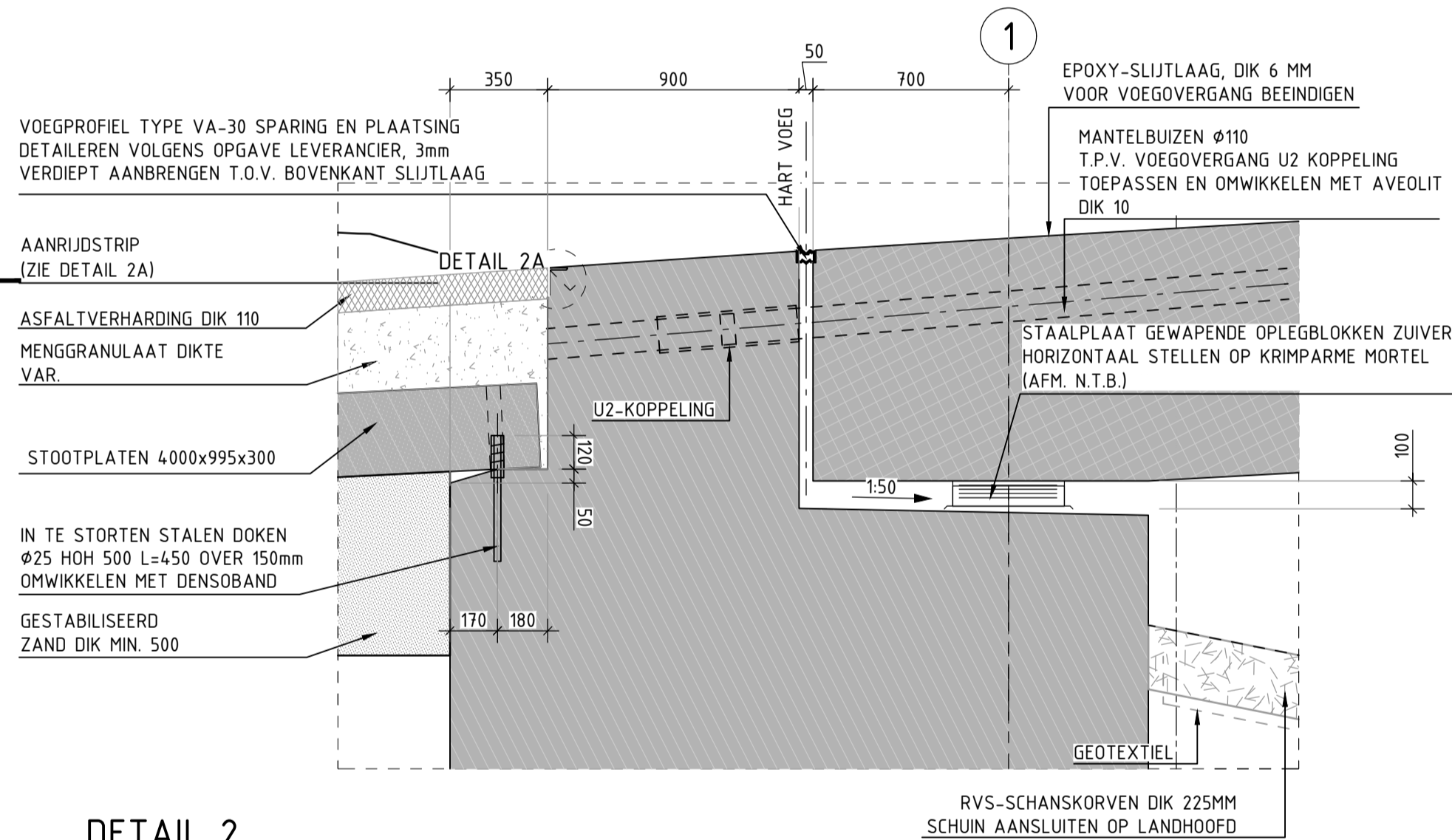

DETAIL 2

SCHAAL 1 : 20
Bovenaanzicht einde voeg

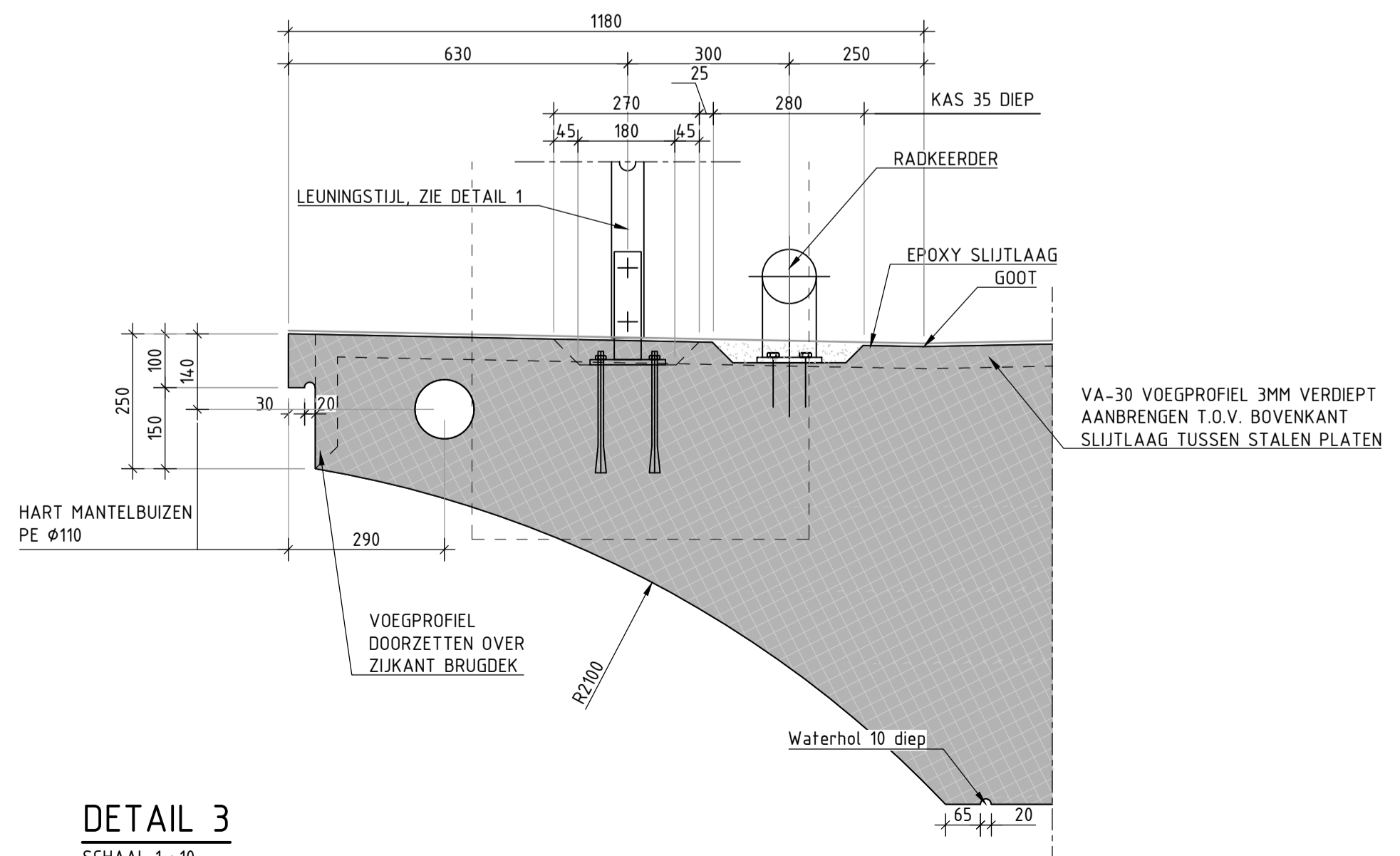

DETAIL 3

SCHAAL 1 : 10
Dekrand

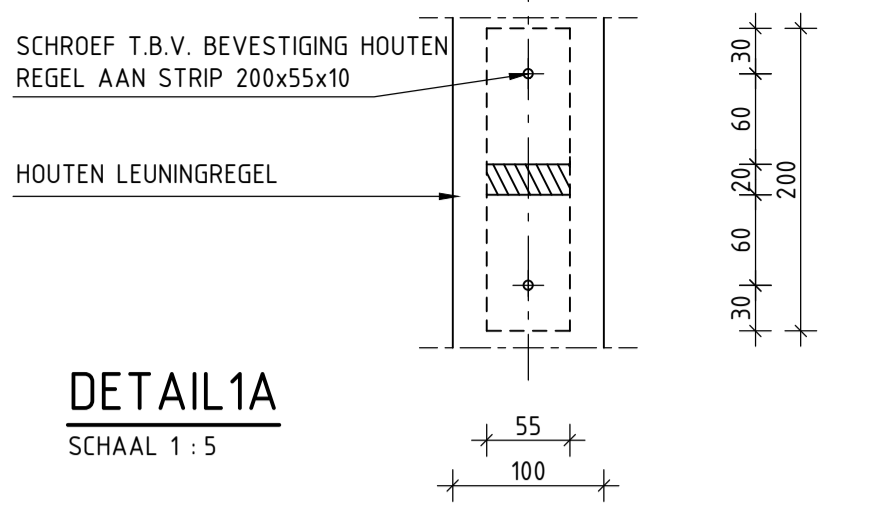
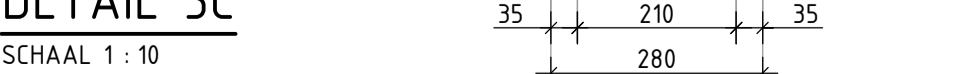
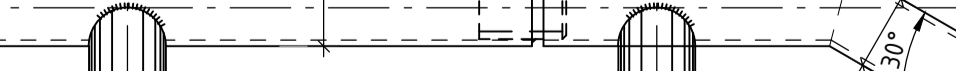
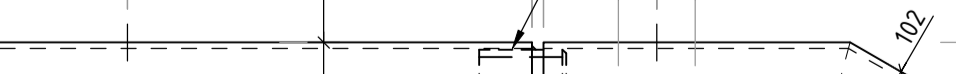
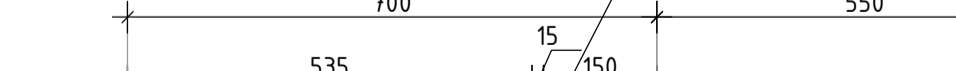
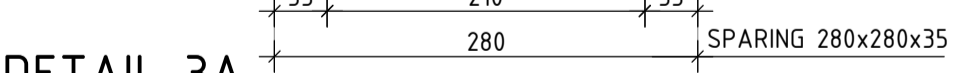
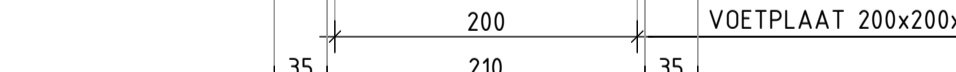
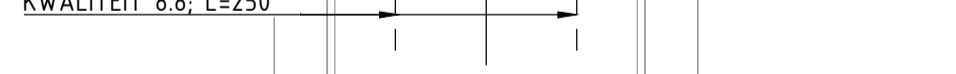
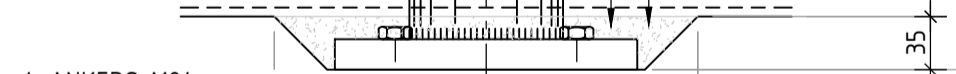
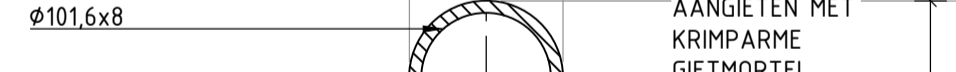
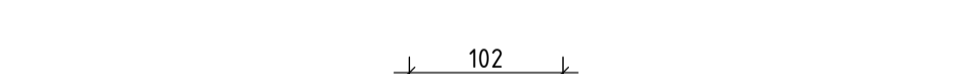
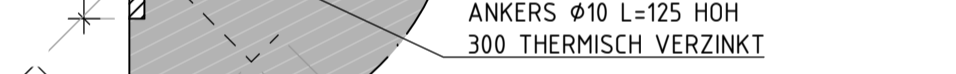
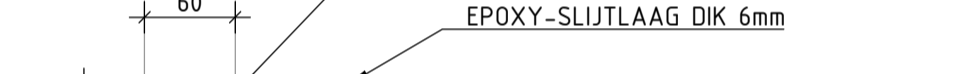
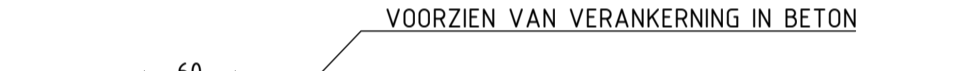
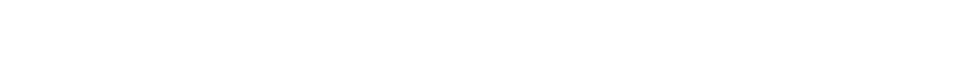
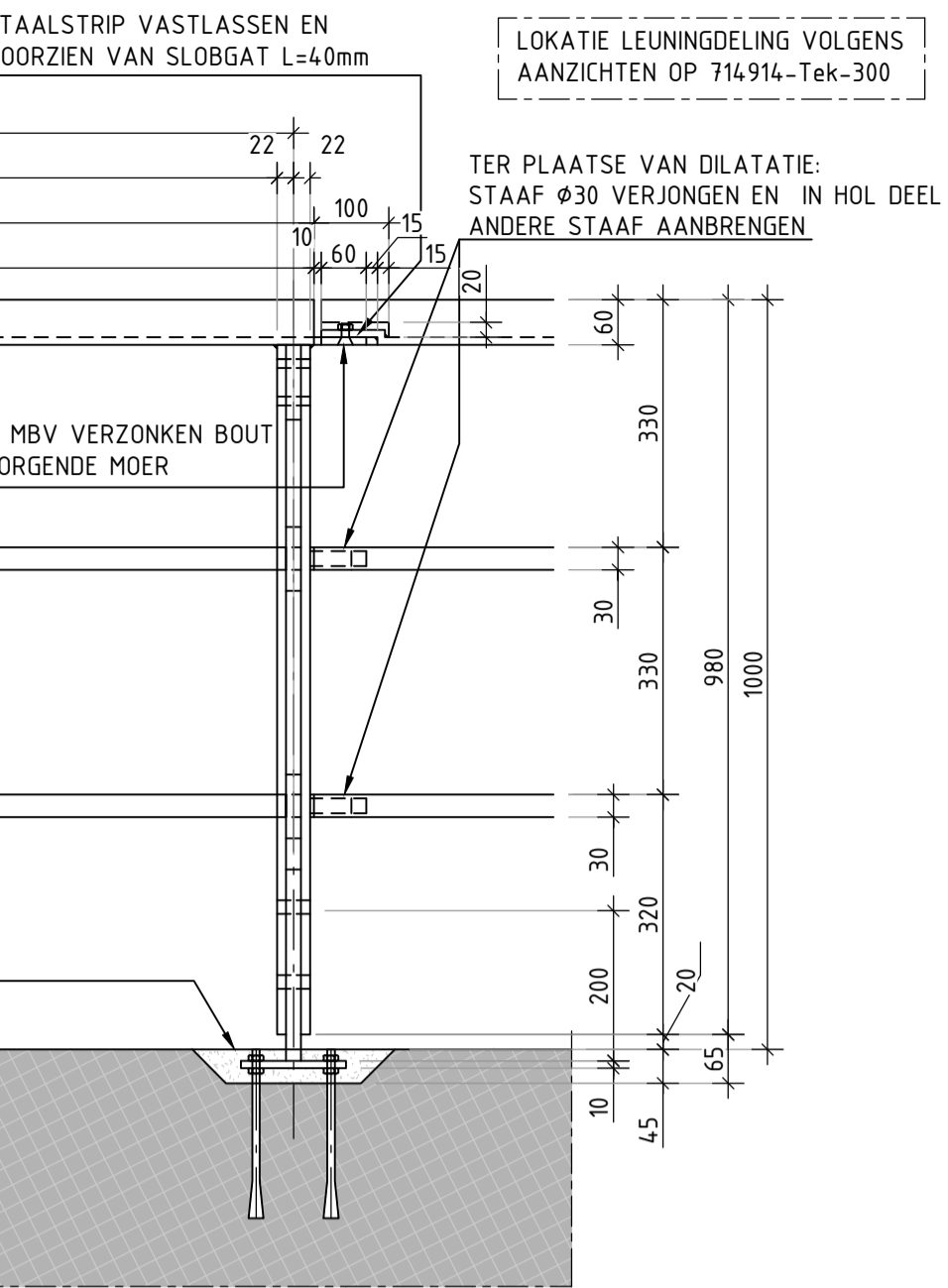

DETAIL 1A

SCHAAL 1 : 5

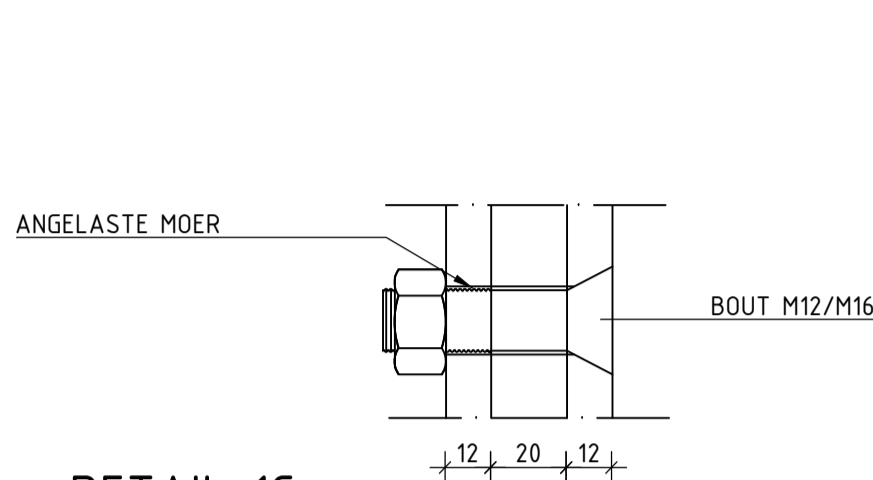

DETAIL 1C

SCHAAL 1 : 2

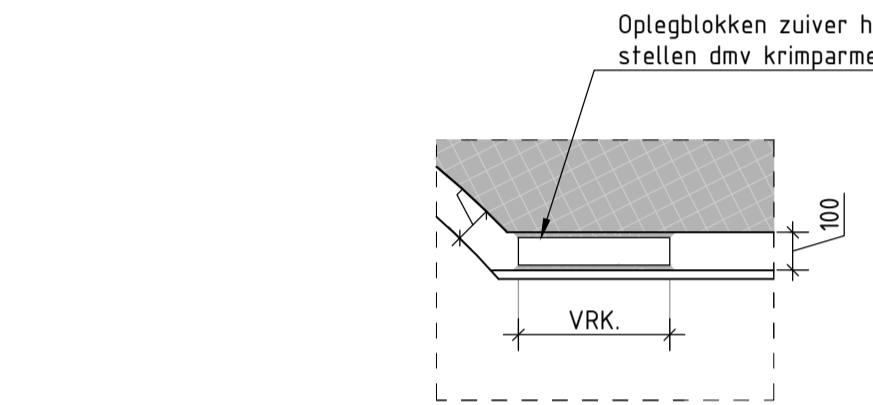

DETAIL 4

SCHAAL 1 : 20

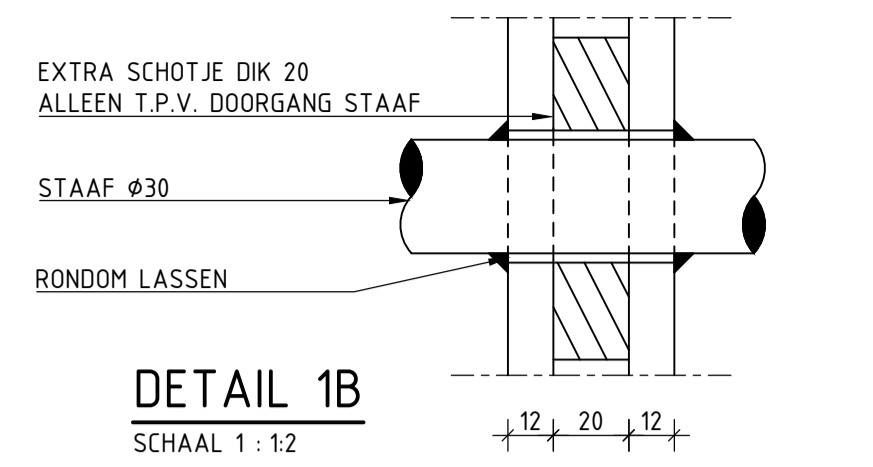

DETAIL 1B

SCHAAL 1 : 12

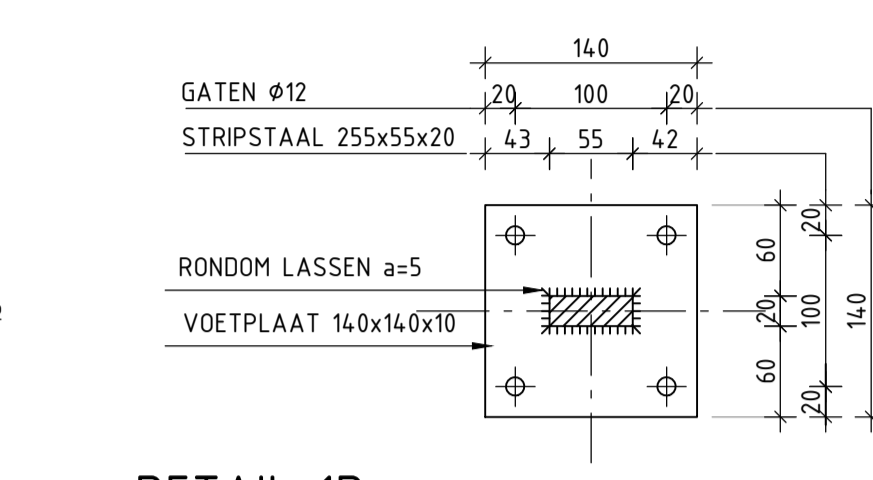

DETAIL 1D

SCHAAL 1 : 5

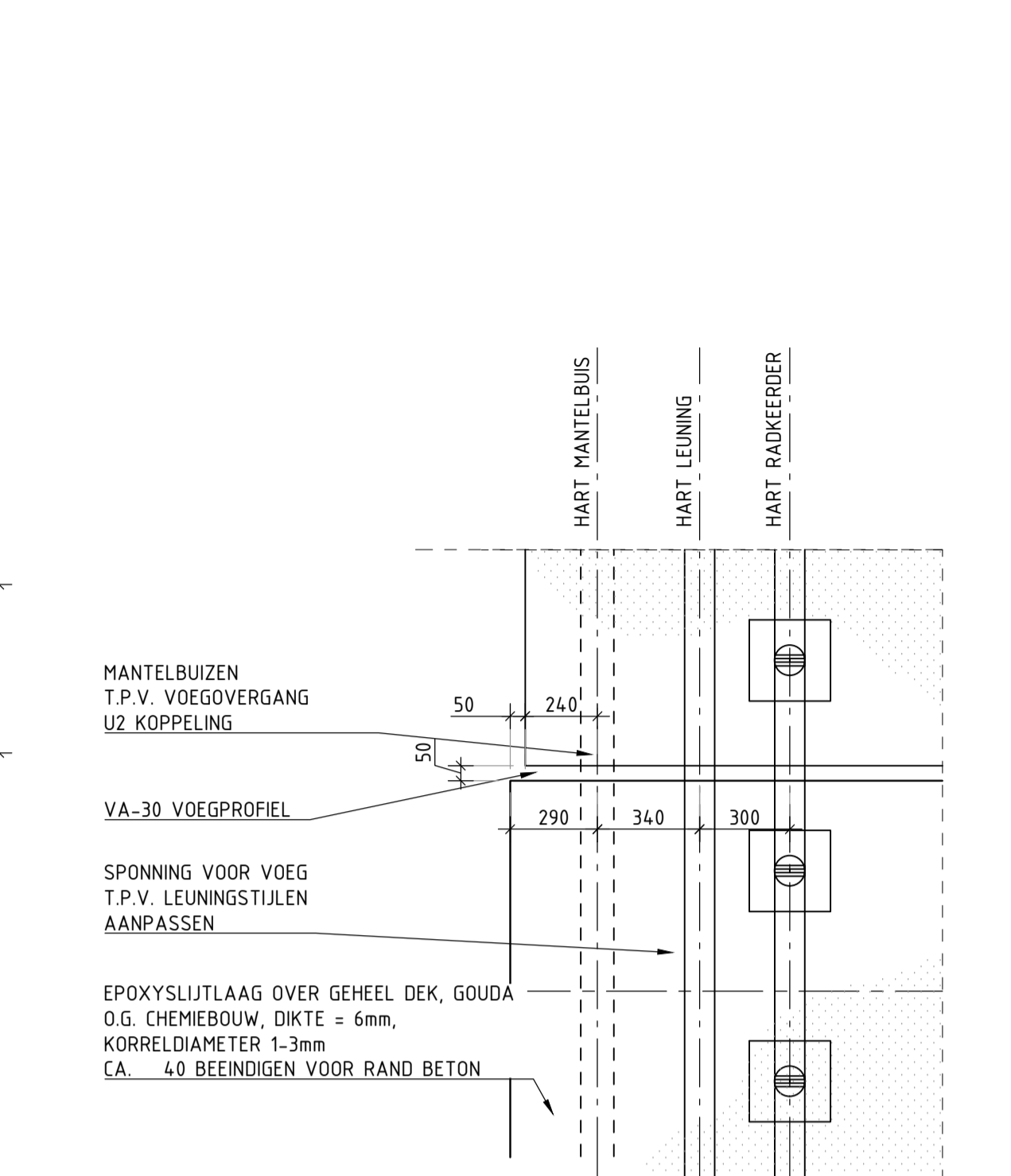

DETAIL 5

SCHAAL 1 : 20
Bovenaanzicht einde voeg

Legenda:					
	Gewapend beton		Staal		Epoxyslijtlaag
	Prefab beton		Menggranulaat		Krimparme mortel
	Voorgespannen beton		Asfalt		
	Gestabiliseerd zand				

Bijbehorende tekeningen:		
- 714.914-tek-300 D0-Overzichtstekening		

Opmerkingen:		
- Maten in millimeters, tenzij anders aangegeven		
- Hoogtemaatvoering in meters t.o.v. N.A.P., tenzij anders aangegeven		
- Coördinaten in millimeters t.o.v. RD-stelsel		
- Hoeken in 360 gradenstelsel, tenzij anders aangegeven		
- Alle stalen onderdelen thermisch verzinken		
- Vellingkanten 15x15 mm		
- Coördinaten controleren door opdrachtgever		

1.0	14-11-2018	Definitief	DPI	JLI		
0.1	30-10-2018		DPI			
Versie	Datum	Omschrijving	Gefekend	Gecontroleerd	Vrijgegeven	

QUMAX2 consultants & engineers	Modelleur: S 5171 SL Kaalshuvel	Postbus 134 5170 AC Kaalshuvel	T: 0416 319 717 F: 0416 319 548	E: info@qumax2.nl I: www.qumax2.nl
--	------------------------------------	-----------------------------------	------------------------------------	---------------------------------------

Opdrachtgever Gebr. de Koning	Projectnummer 714.914
Project Brug Parkstrook Vleuterweide	Projectfase Definitief ontwerp
Onderdeel D0-Detailblad	Schaal Zie Tekening
	Formaat A0
	Status Definitief
	Versie 1.0
	Tekeningnummer 714.914-TEK-301